

EAN: 4057304021619
static.hansa.com/4719911381



HANSAAURELIA A Harmony of Simplicity and Elegance.

The design of HANSAAURELIA is characterized by pure, fluid shapes—timeless in their simplicity yet subtly complex in execution. This results in a delicate dance between the straightforward and the intricate, visually capturing nature's own balance.

Stand beneath the cascading water to experience a symphony of sensations, as clever design ensures efficient water distribution, embracing the complete body in refreshing and rejuvenating comfort.

Elevate your daily ritual with HANSAAURELIA, where every drop becomes a celebration of inherent beauty.

w/ s-connectors and covers
 1-spray, 250x250 overhead shower
 1-spray stick hand shower
 1750mm hose

ELEVATING YOUR MOMENTS

- Shower solutions
- Thermostatic
- Wall mounted
- Brushed bronze
- Temperature control handle, Flow control handle, Hot/Cold symbols, Eco feature for water flow
- Turn operated diverter, Integrated into flow control handle
- Hand shower, Swivel overhead shower, Lockable in the middle position, Rotatable ball joint connection, Shower rail, Variable fixing points, Adjustable shower rail bracket, Anti limescale technology (easy to clean), Shower hose (1750 mm), Twist guard for shower hose
- Normal - Even and soft water stream
- Safety stop against scalding at 38°C, The housing of the fittings conducts minimal heat
- Thermostatic cartridge for automatic temperature control, Non-return valve(s), Litter filter(s)
- Direct connection, Internal thread, Cover plate(s)
- Flexible length / can be shortened, Anti-twist hose connector
- 1 spray function

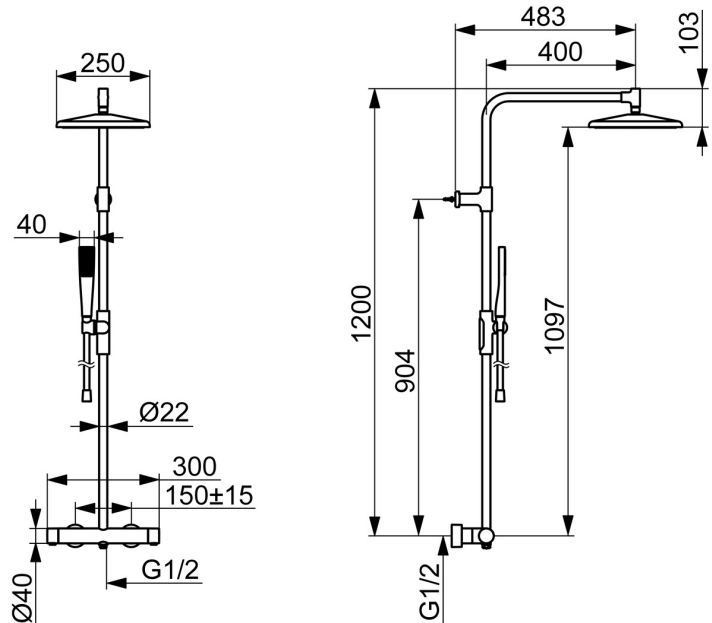
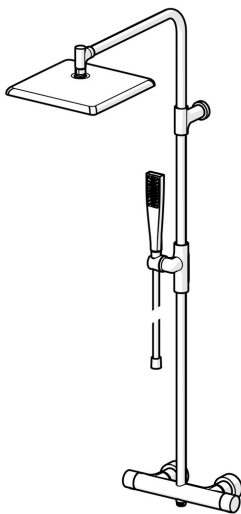

Technical data

Flow properties

Eco-flow at 3 bar	7.2 l/min
Flow-rate at 3 bar	7.8 l/min

Technical properties

Hot water supply	max. +65°C
Working pressure	1-10 bar
Connection size	G3/4
Installation width	150 ± 15 mm
Backflow prevention (EN1717)	EB
Material	Brass/Plastic

Regulations

EN standard	EN 1111, EN 1112, EN 1113
Noise class	I (ISO 3822)

Approvals and Declarations

Declaration of conformity	DoC
---------------------------	------------

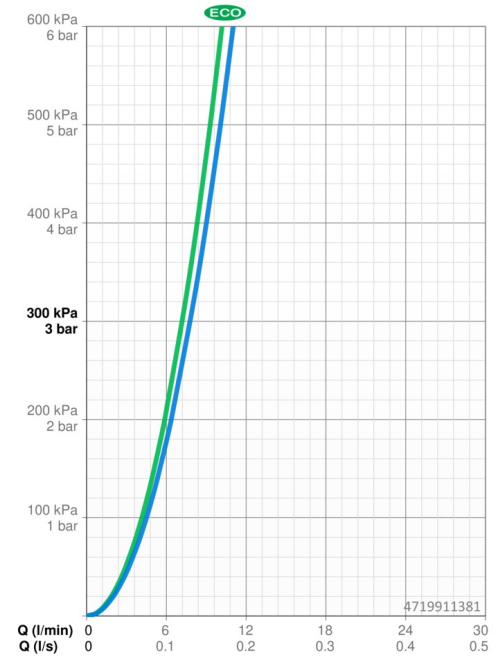

Spare parts

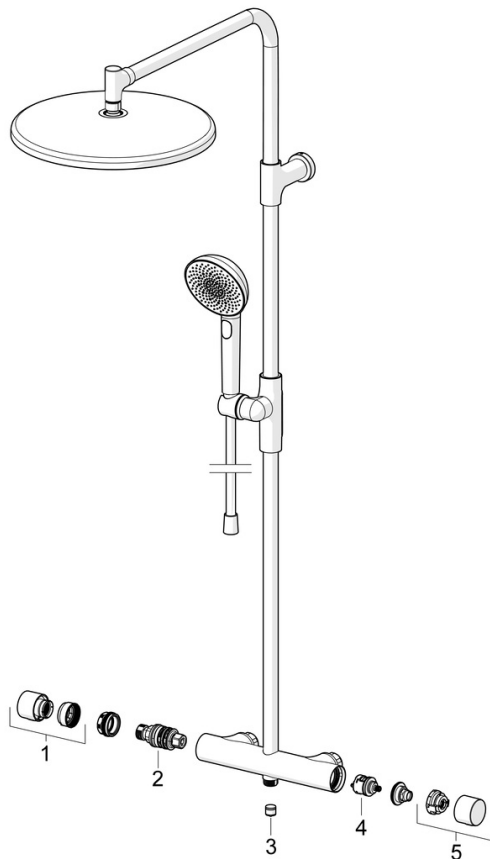

SP47199103CLR

	Name	Code
01	Temperature control handle Matt black	1018476V-33
01	Temperature control handle Brushed steel	1018476V-80
01	Temperature control handle Brushed bronze	1018476V-81
02	Thermostatic cartridge, 3.4	59914114
03	Non-return valve, DW15/DN10K	1018484V
04	Diverter	59914183
05	Flow control handle Matt black	1018477V-33
05	Flow control handle Brushed steel	1018477V-80
05	Flow control handle Brushed bronze	1018477V-81